

Traffic signals removed at Palmerston Road junction

One-way NB on High Street

Canning Road WB only for buses

New SB bus lane on A409

One-way WB on Palmerston Road

New signalled junction at Canning Road

APPENDIX A – TOWN CENTRE AND BUS IMPROVEMENT SCHEME

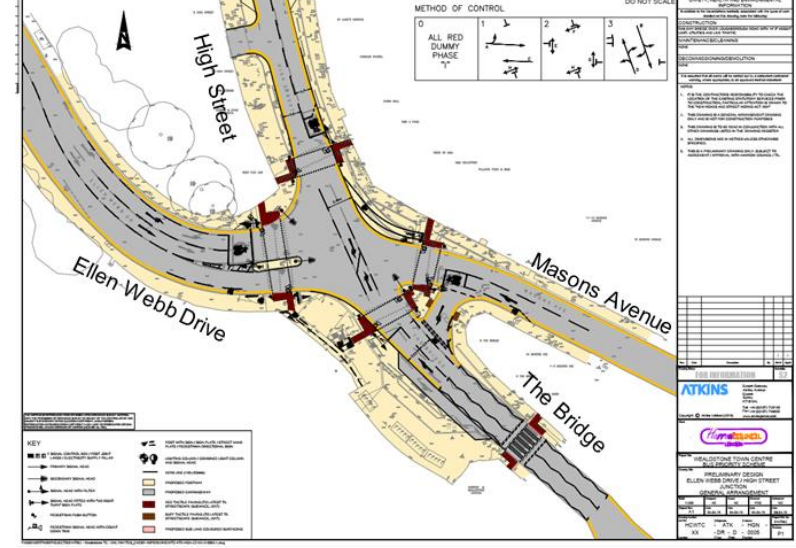
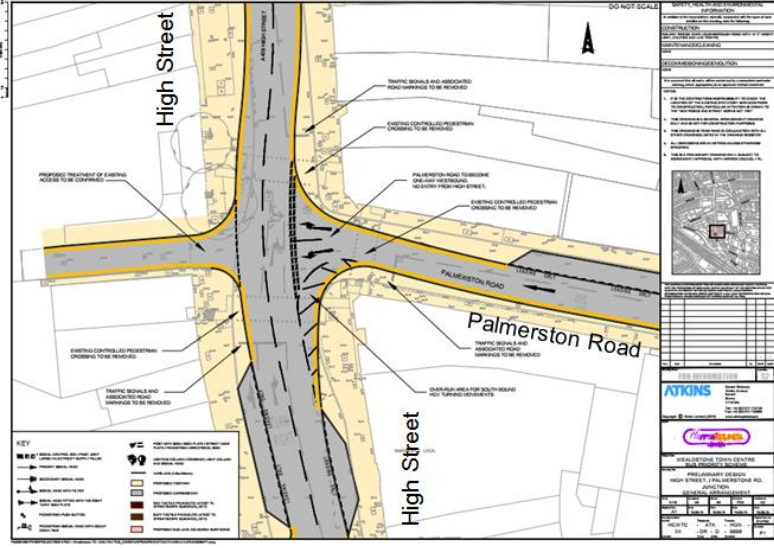
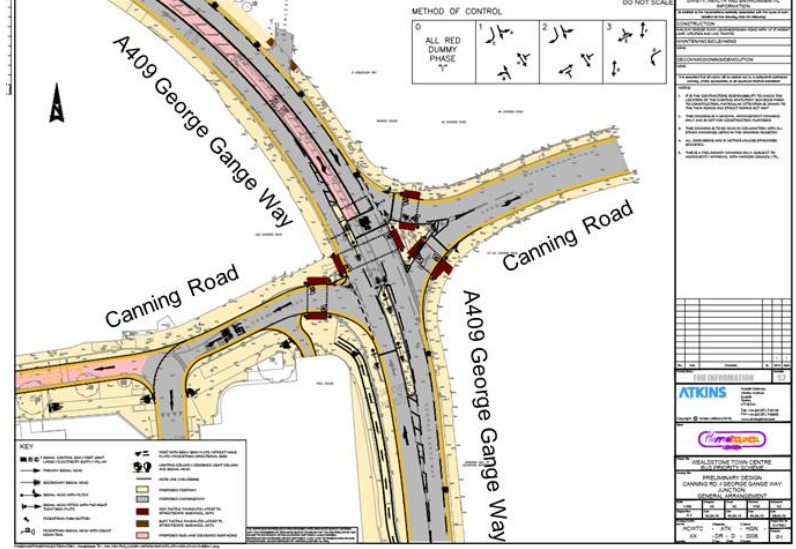
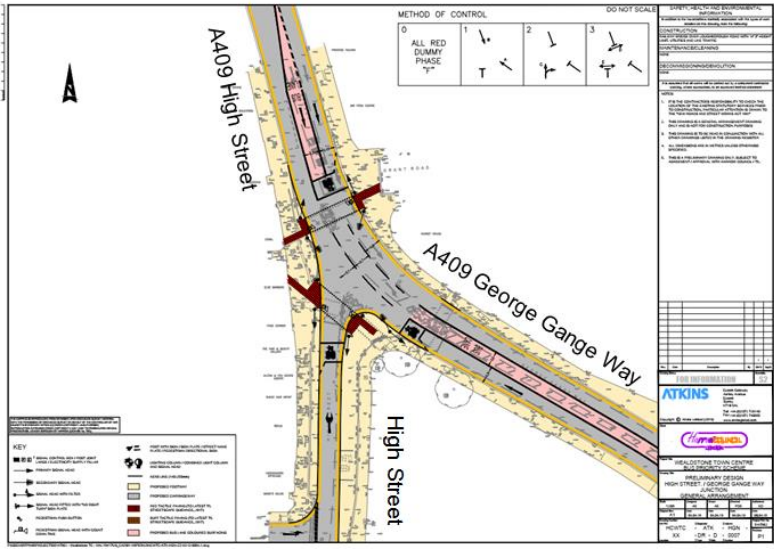

Buses from Harrow & Wealdstone

Key

- Connections with London Underground
- Connections with London Overground
- Connections with National Rail

A Red discs show the bus stop you need for your chosen bus service. The disc **A** appears on the top of the bus stop in the street (see map of town centre in centre of diagram).

Route finder

Day buses

Bus routes	Towards	Bus stops
140	Harrow Weald	C G K N
	Heathrow Terminals 1, 2, 3	D F L M
182	Brent Cross	D F L M
	Harrow Weald	C G K N
186	Brent Cross	A G K N
	Northwick Park Hospital	B F L M
258	South Harrow	D F L M
	Watford Junction	C G K N
340	Edgware	C G K N
	Harrow	D F L M
H9	Harrow via Rayners Lane	F J S T X Y Z
H10	Harrow via Kenton	E G H P R U V
H14	Hatch End	W
	Northwick Park Hospital	G

Night buses

Bus routes	Towards	Bus stops
N18	Harrow Weald	C G K N
	Trafalgar Square	D F L M

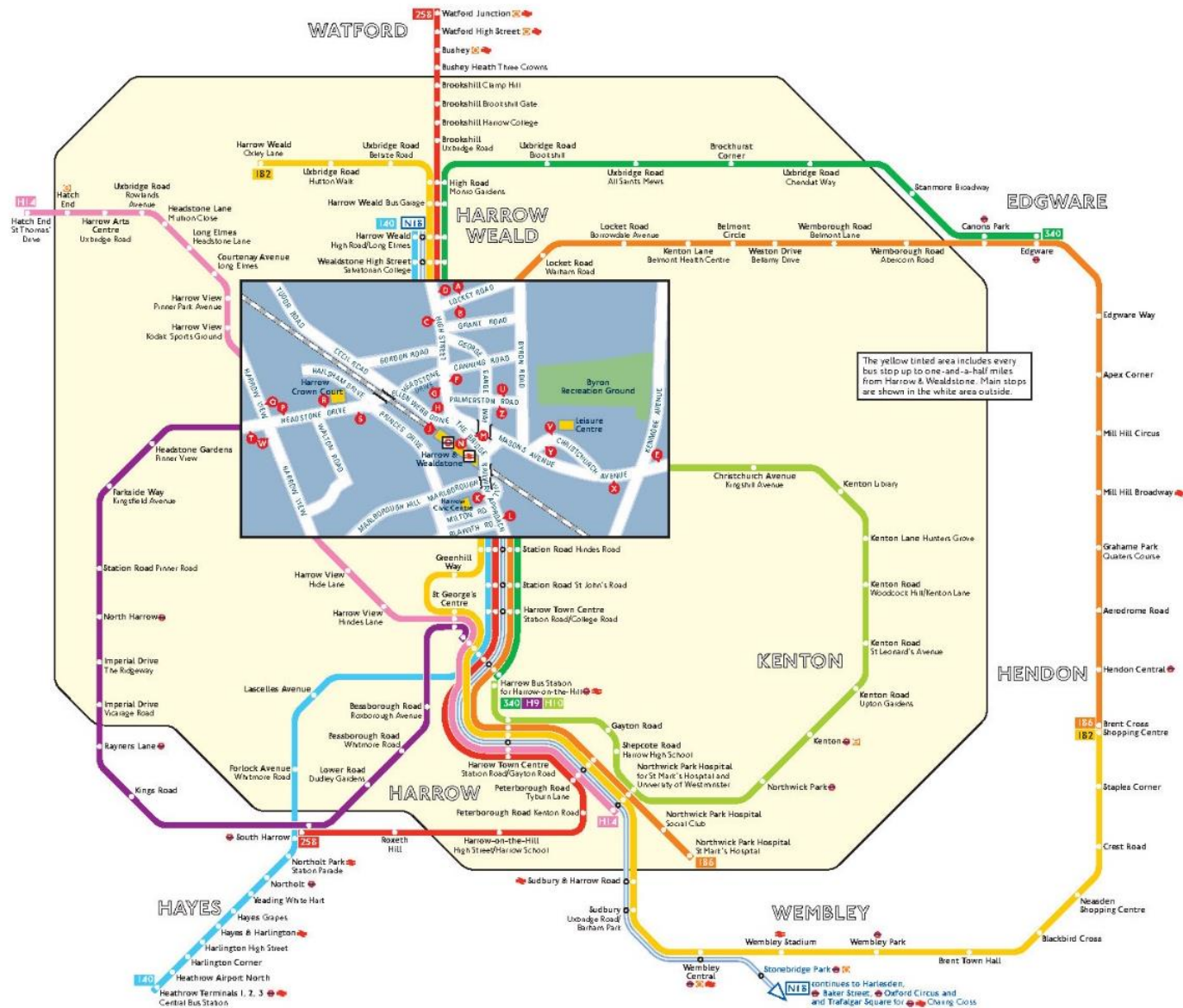

Buses	Journey Time Savings (secs)	
	AM Peak	PM Peak
H9	-52	-104
H10	-54	-131
182 SB	-61	-49
186 SB	-14	-43
140 SB	-61	-50
258 SB	-56	-60
340 SB	-50	-53
182 NB	-17	-138
186 NB	-11	-130
140 NB	-22	-142
258 NB	-36	-138
340 NB	-30	-135

