

# **Planning Committee**

## **OS maps**

**DATE:                      Wednesday 2 December 2009**

This page is intentionally left blank

2 DECEMBER 2009

# Agenda Annex Pages 1 to 24

1/01



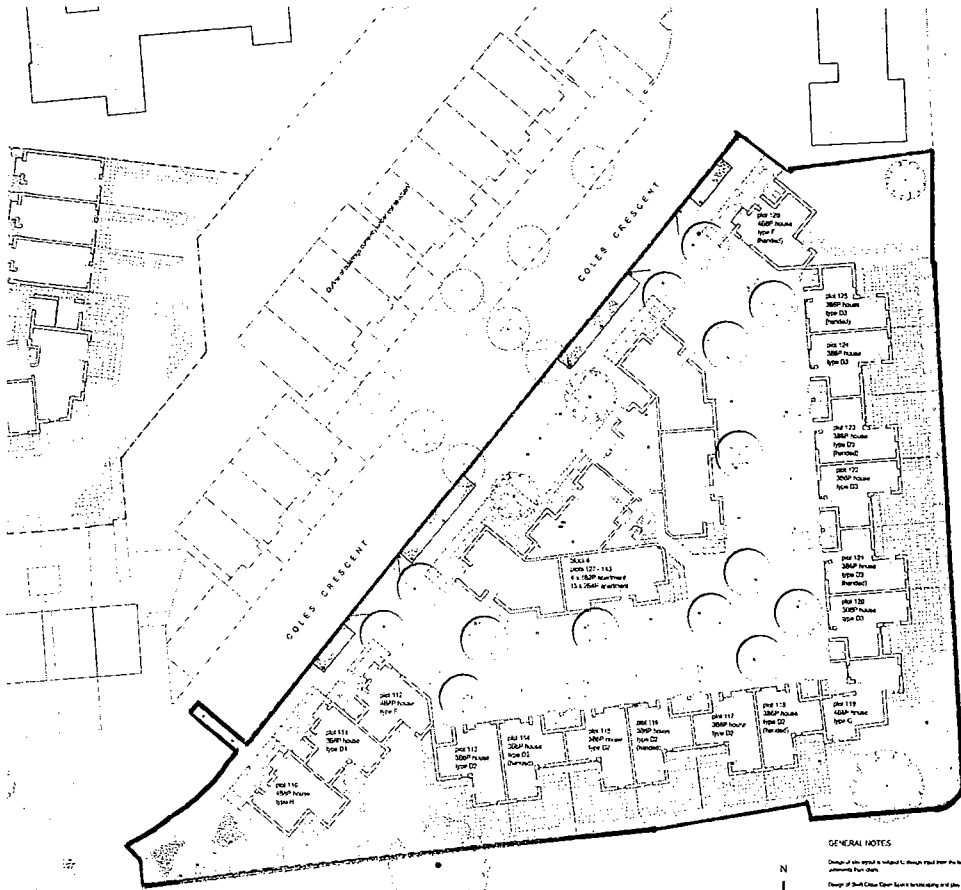

Tree to be retained

- Existing trees to be retained, subject to landscaping and structural conditions. Tree protection areas and measures shall be implemented in accordance with the requirements of the Local Government Act 2002.
- Planting schedule for trees and shrubs to be retained and new planting to be completed in accordance with the requirements of the Local Government Act 2002.
- Planting to be completed in accordance with the requirements of the Local Government Act 2002.
- Planting to be completed in accordance with the requirements of the Local Government Act 2002.
- Planting to be completed in accordance with the requirements of the Local Government Act 2002.
- Planting to be completed in accordance with the requirements of the Local Government Act 2002.
- Planting to be completed in accordance with the requirements of the Local Government Act 2002.
- Planting to be completed in accordance with the requirements of the Local Government Act 2002.
- Planting to be completed in accordance with the requirements of the Local Government Act 2002.
- Planting to be completed in accordance with the requirements of the Local Government Act 2002.
- Planting to be completed in accordance with the requirements of the Local Government Act 2002.

**Rayners Lane Estate Big Phase E**  
Site plan  
Scale: 1:1000

**FOR PLANNING**

Date:	1/01/2024
Project:	Rayners Lane Estate Big Phase E
Client:	Rayners Lane Estate
Designer:	Rayners Lane Estate

**NOTE**  
This drawing contains technical information that may not be clear if printed or reproduced in monochrome.

- GENERAL NOTES**
- Design of the site to be subject to approval from the local authorities and the Council of the City of Auckland.
- Design of the site to be subject to approval from the local authorities and the Council of the City of Auckland.
- Design of the site to be subject to approval from the local authorities and the Council of the City of Auckland.
- Design of the site to be subject to approval from the local authorities and the Council of the City of Auckland.
- Design of the site to be subject to approval from the local authorities and the Council of the City of Auckland.

This map is reproduced from Ordnance Survey material with the permission of Ordnance Survey on behalf of the controller of Her Majesty's Stationery Office. Crown Copyright. Unauthorised reproduction infringes Crown Copyright and may lead to prosecutions or civil proceedings. London Borough of Harrow LA.100019206. 2007.

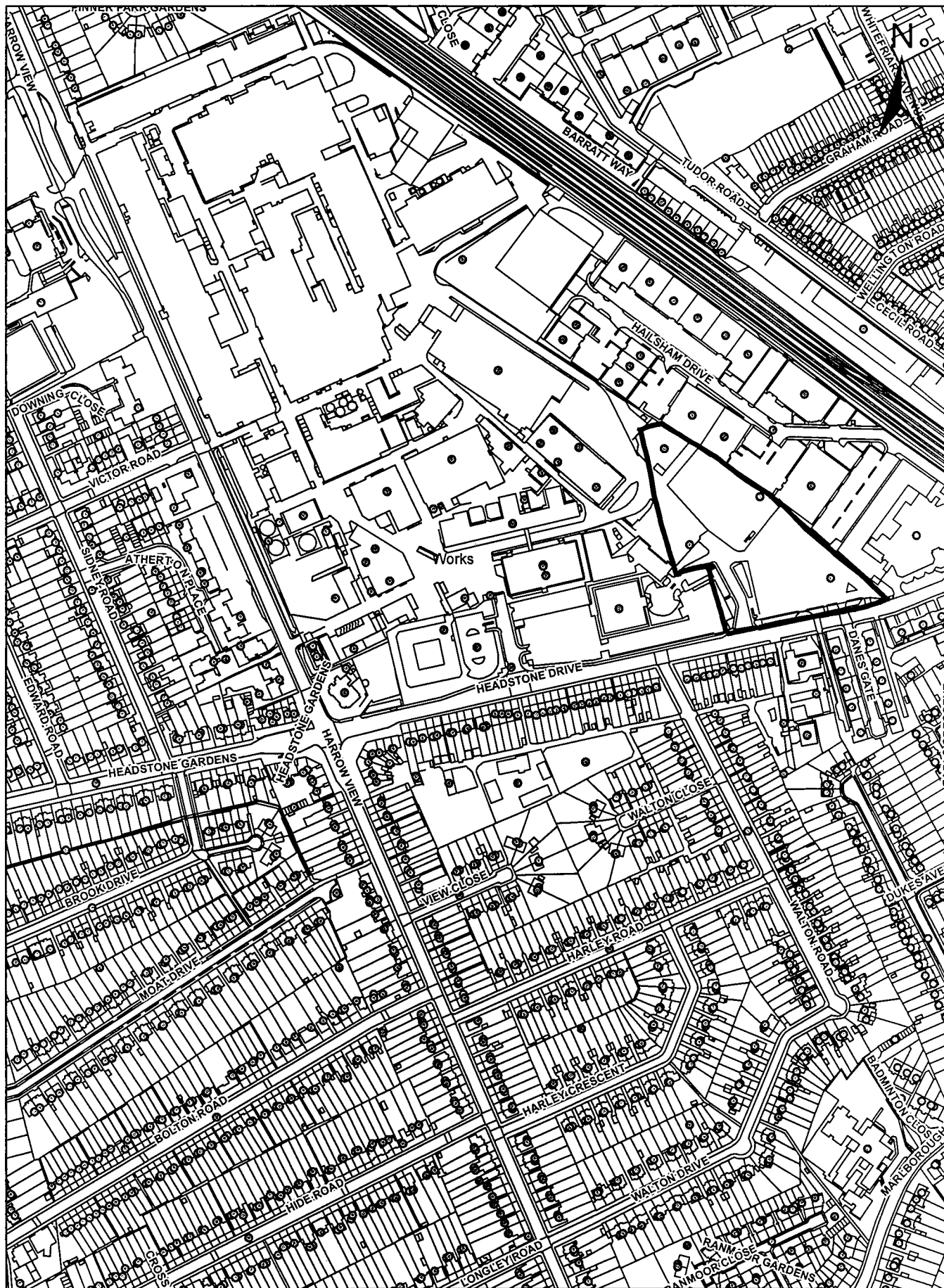

# Goodwill to All, Headstone Drive, Wealdstone HA1 4UN

This map is reproduced from Ordnance Survey material with the permission of Ordnance Survey on behalf of the controller of Her Majesty's Stationery Office. Crown Copyright. Unauthorised reproduction infringes Crown Copyright and may lead to prosecutions or civil proceedings. London Borough of Harrow LA.100019206. 2007.



This map is reproduced from Ordnance Survey material with the permission of Ordnance Survey, on behalf of the controller of Her Majesty's Stationery Office. Crown Copyright. Unauthorised reproduction infringes Crown Copyright and may lead to prosecutions or civil proceedings. London Borough of Harrow LA.100019206. 2007.

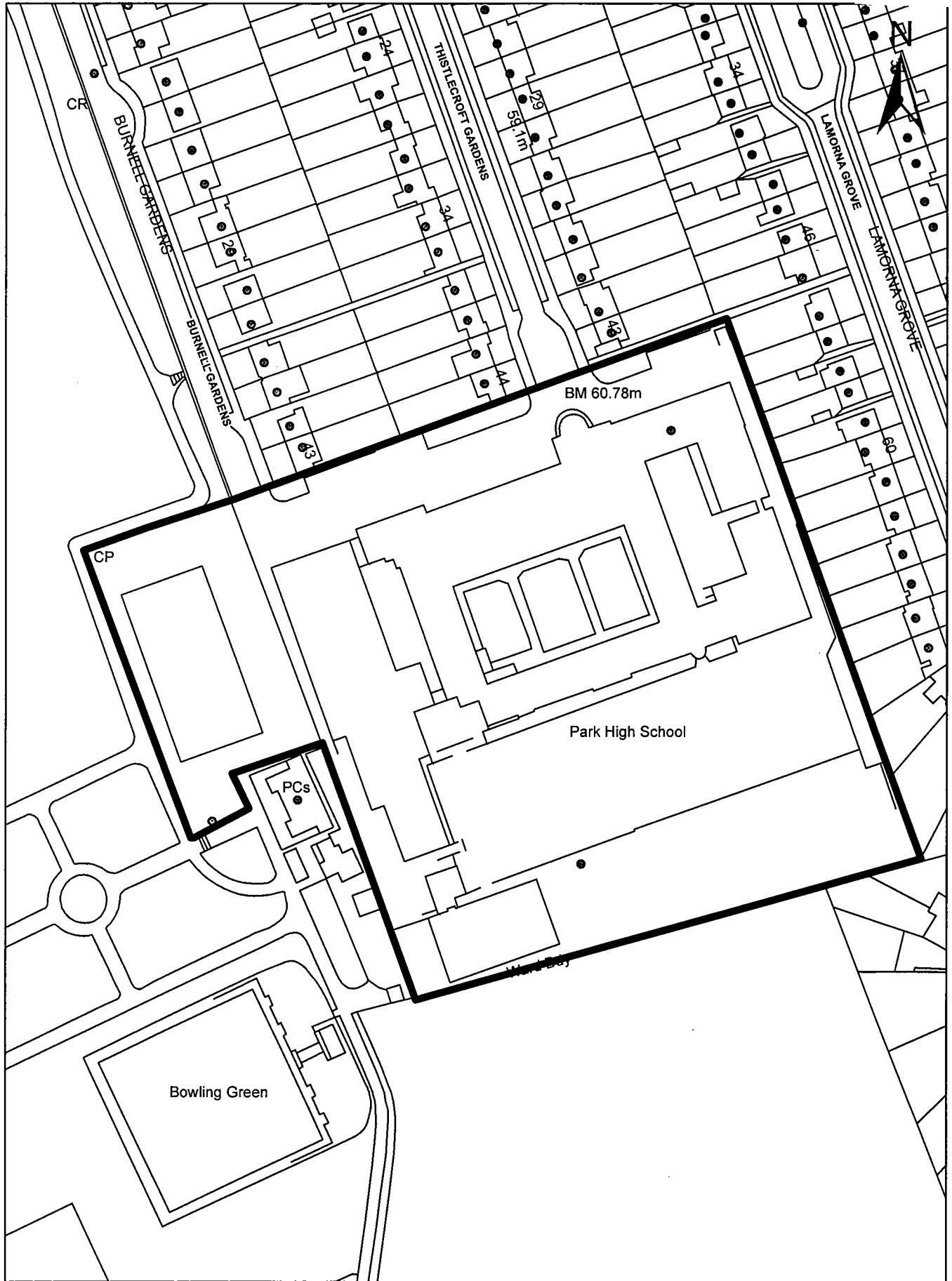

This map is reproduced from Ordnance Survey material with the permission of Ordnance Survey, on behalf of the controller of Her Majesty's Stationery Office. Crown Copyright. Unauthorised reproduction infringes Crown Copyright and may lead to prosecutions or civil proceedings. London Borough of Harrow LA.100019206. 2007.

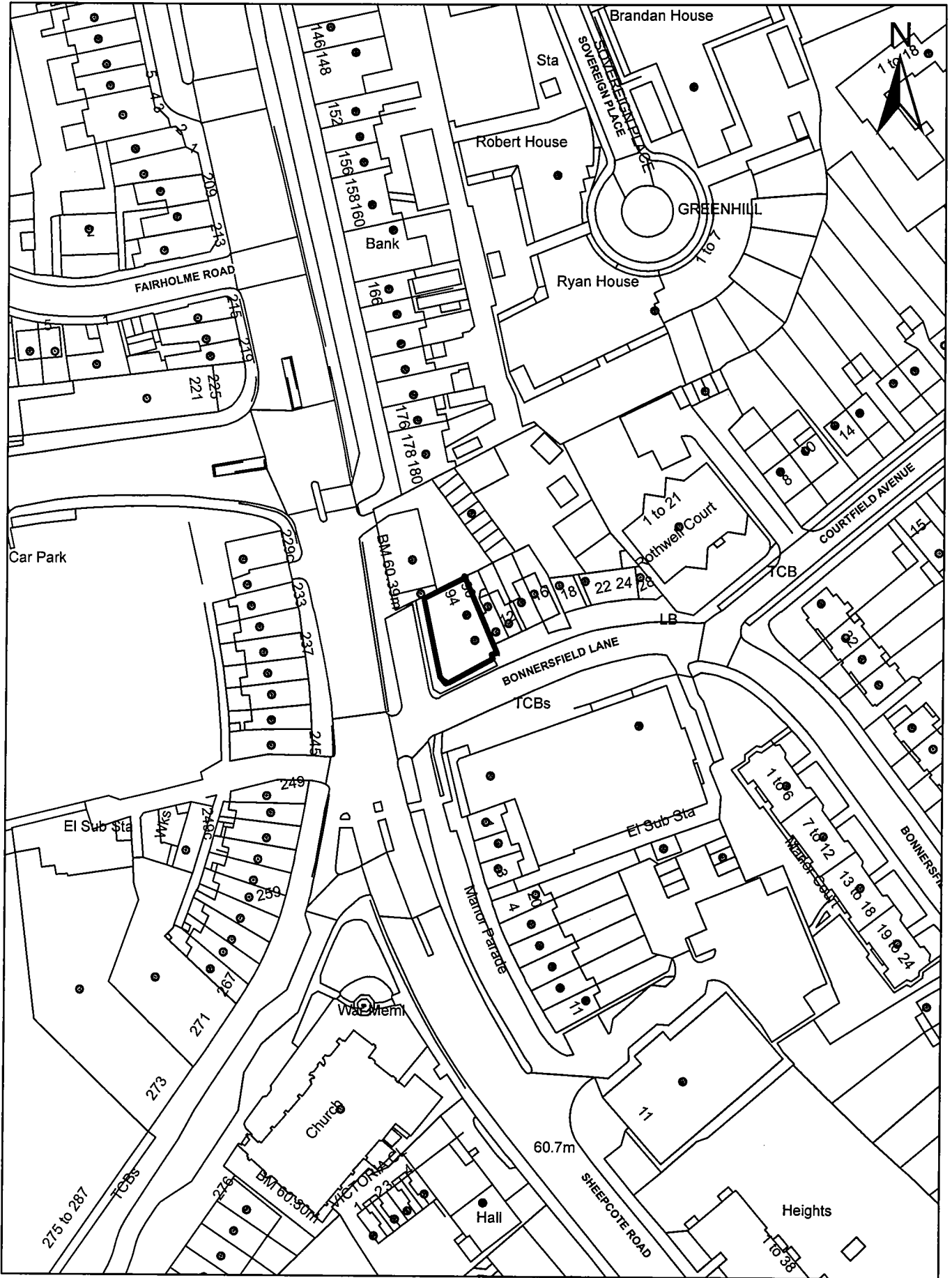



This map is reproduced from Ordnance Survey material with the permission of Ordnance Survey on behalf of the controller of Her Majesty's Stationery Office. Crown Copyright. Unauthorised reproduction infringes Crown Copyright and may lead to prosecutions or civil proceedings. London Borough of Harrow LA.100019206. 2007.

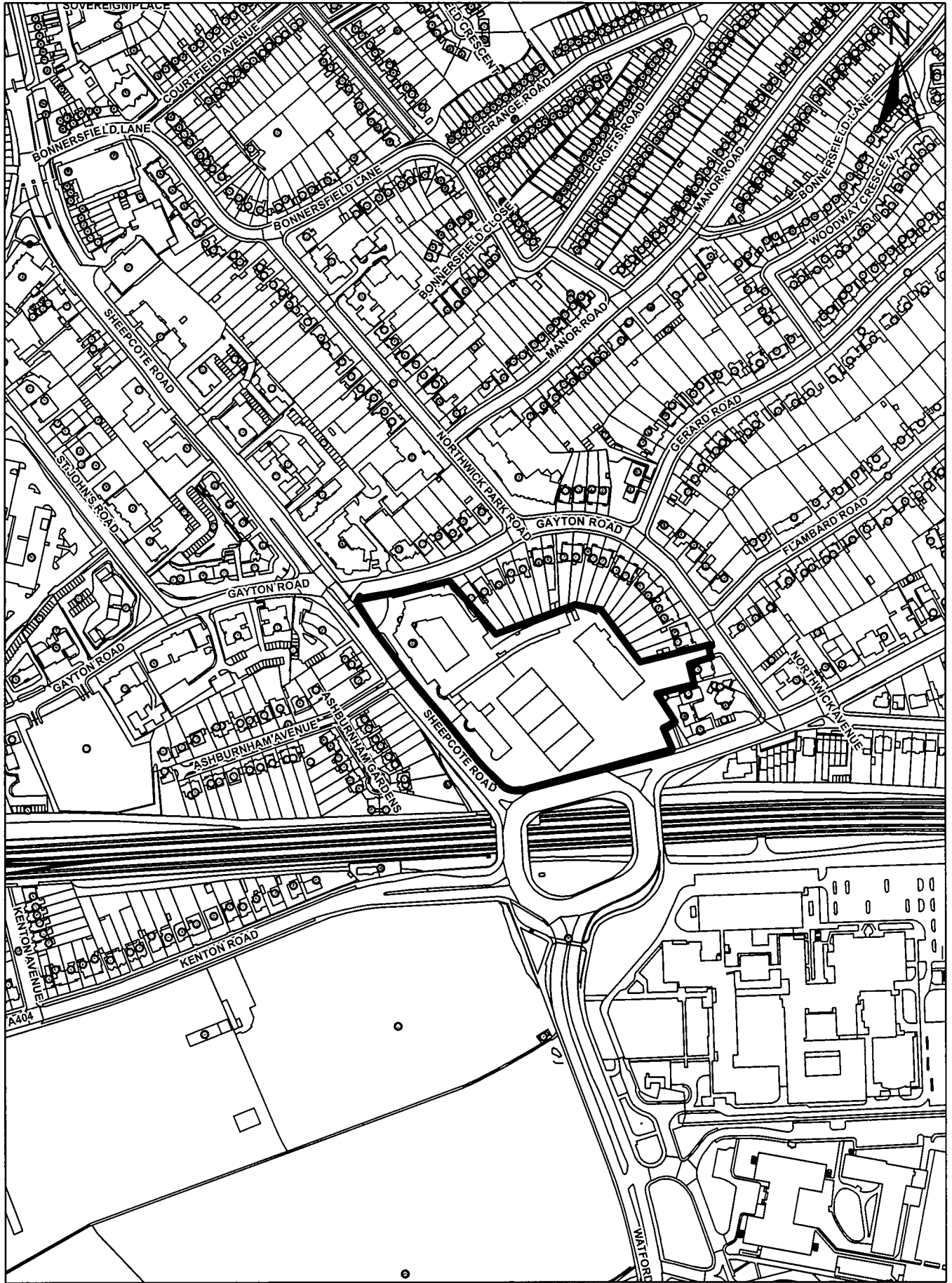

# 12 High Street, Wealdstone HA3 7AA

2/02

This map is reproduced from Ordnance Survey material with the permission of Ordnance Survey on behalf of the controller of Her Majesty's Stationery Office. Crown Copyright. Unauthorised reproduction infringes Crown Copyright and may lead to prosecutions or civil proceedings. London Borough of Harrow LA. 100019206. 2007.

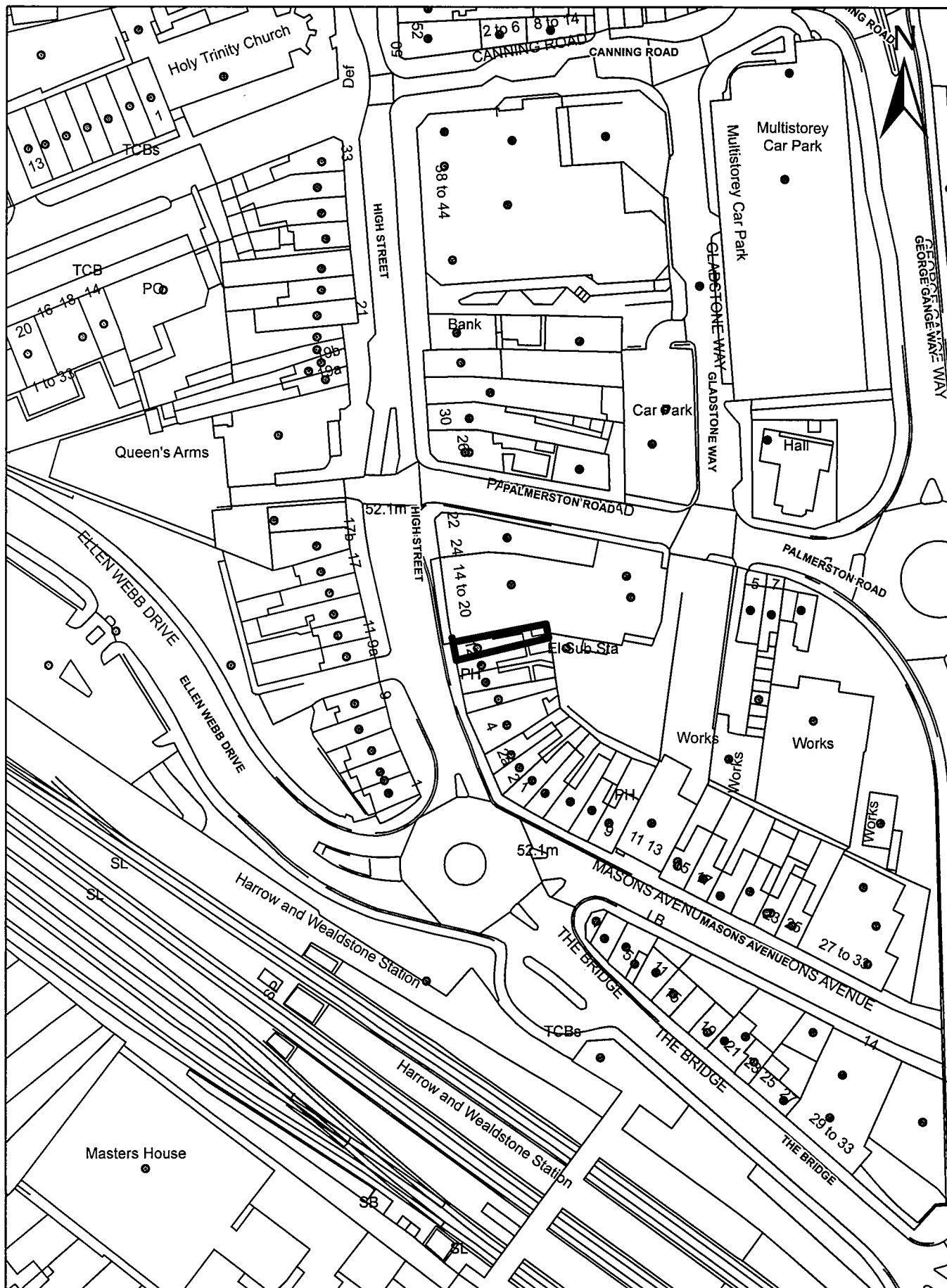

# Stanburn First & Middle School Abercorn Road, Stanmore HA7 2PJ

This map is reproduced from Ordnance Survey material with the permission of Ordnance Survey on behalf of the controller of Her Majesty's Stationery Office. Crown Copyright. Unauthorised reproduction infringes Crown Copyright and may lead to prosecutions or civil proceedings. London Borough of Harrow LA.100019206. 2007.

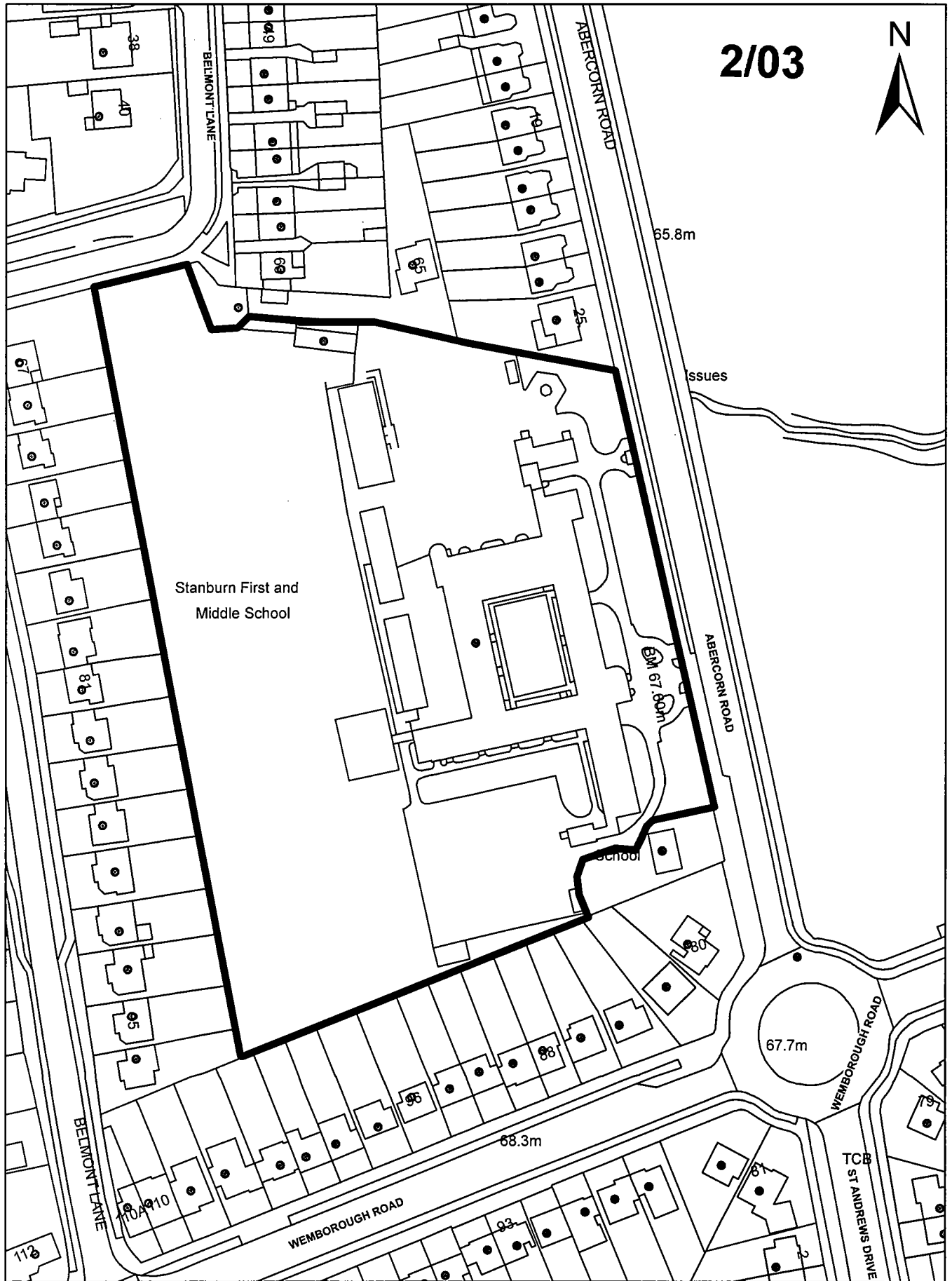

**2/04**  
**26 Culver Grove, Stanmore**



This map is reproduced from Ordnance Survey material with the permission of Ordnance Survey on behalf of the controller of Her Majesty's Stationery Office. Crown Copyright. Unauthorised reproduction infringes Crown Copyright and may lead to prosecutions or civil proceedings. London Borough of Harrow LA.100019206. 2007.

# Woodfield House, 506-508 Honeypot Lane, Stanmore HA7 1LA



2/06

47 Du Cros Drive, Stanmore

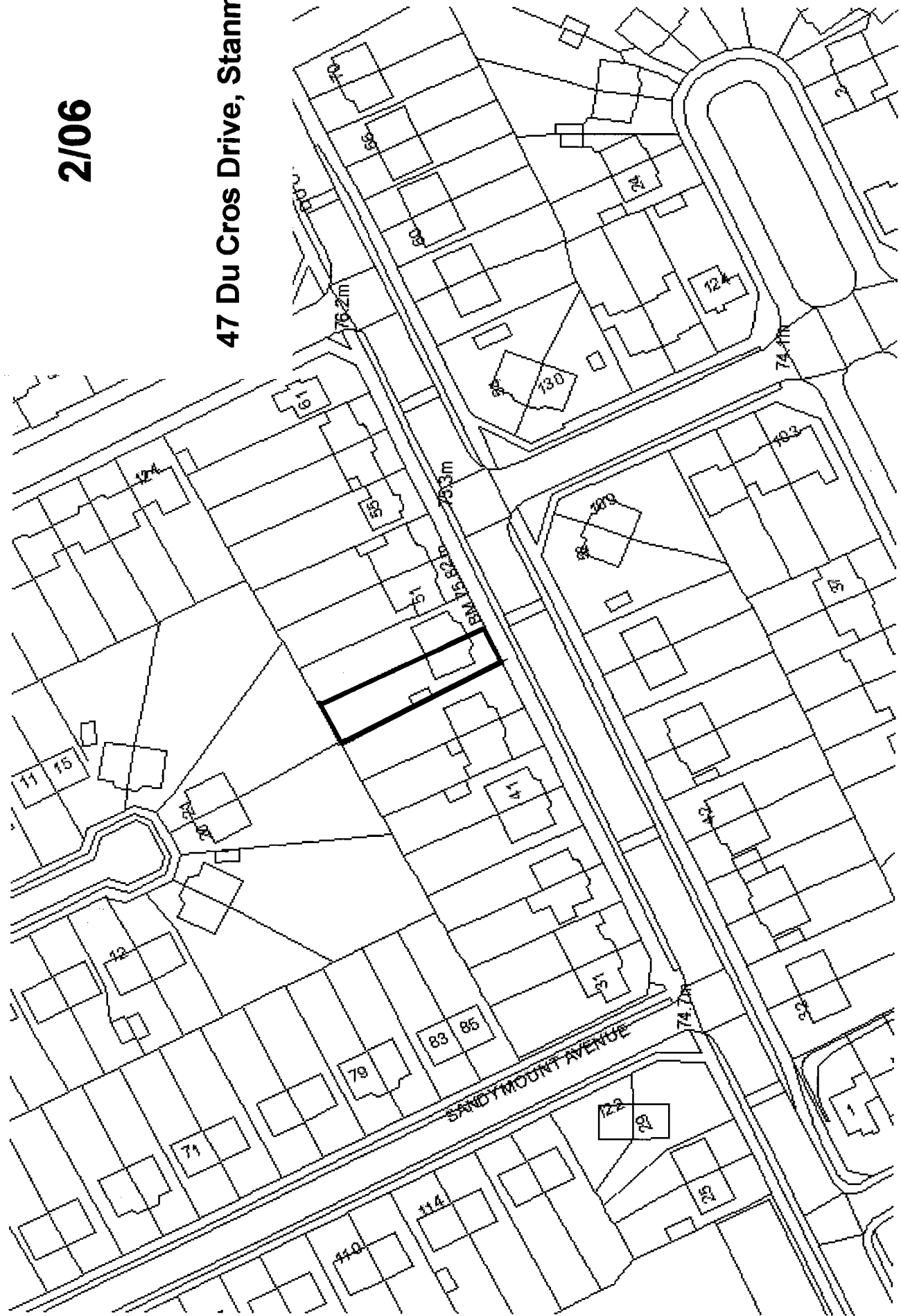

This map is reproduced from Ordnance Survey material with the permission of Ordnance Survey on behalf of the controller of Her Majesty's Stationery Office. Crown Copyright. Unauthorised reproduction infringes Crown Copyright and may lead to prosecutions or civil proceedings. London Borough of Harrow LA.100019206. 2007.

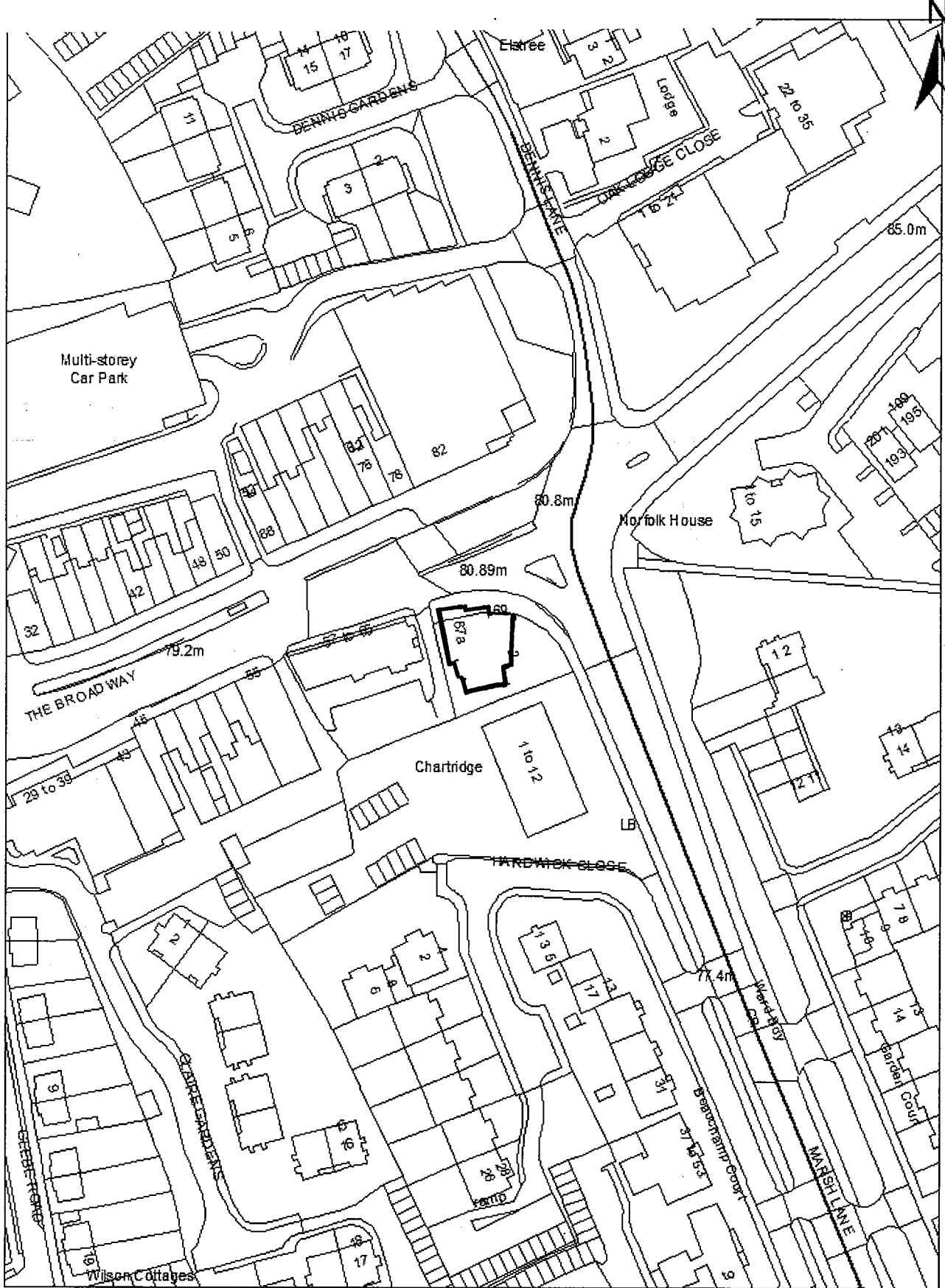

0 10 20 Meters



9 Buckingham Parade, The Broadway, Stanmore HA7 4EB

This map is reproduced from Ordnance Survey material with the permission of Ordnance Survey, on behalf of the controller of Her Majesty's Stationery Office. Crown Copyright. Unauthorised reproduction infringes Crown Copyright and may lead to prosecutions or civil proceedings. London Borough of Harrow LA.100019206. 2007.

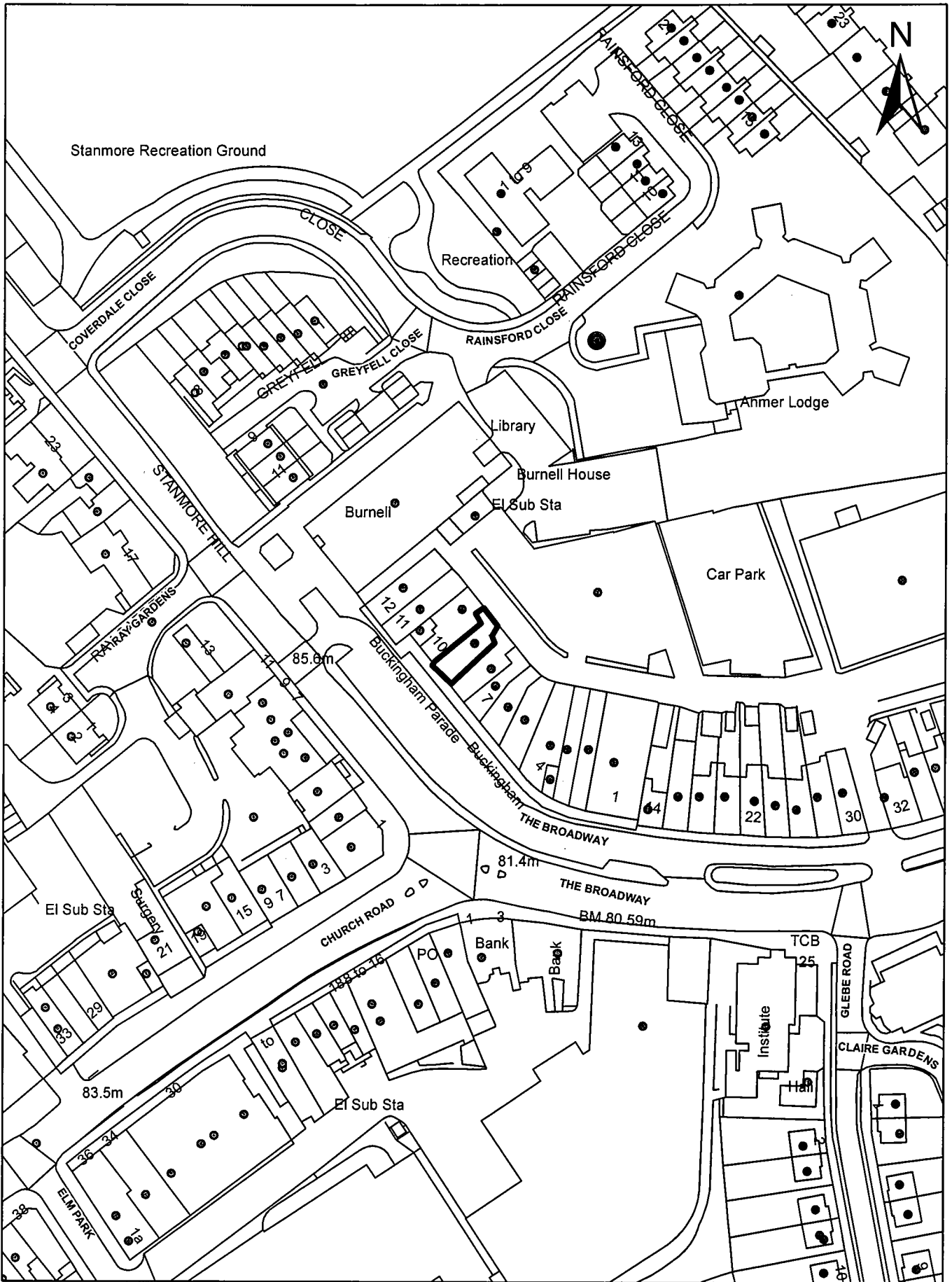



This map is reproduced from Ordnance Survey material with the permission of Ordnance Survey on behalf of the controller of Her Majesty's Stationery Office. Crown Copyright. Unauthorised reproduction infringes Crown Copyright and may lead to prosecutions or civil proceedings. London Borough of Harrow LA. 100019206. 2007.

# UNIT 3 BALLARDS MEWS, HIGH STREET, EDGWARE HA8 7BZ

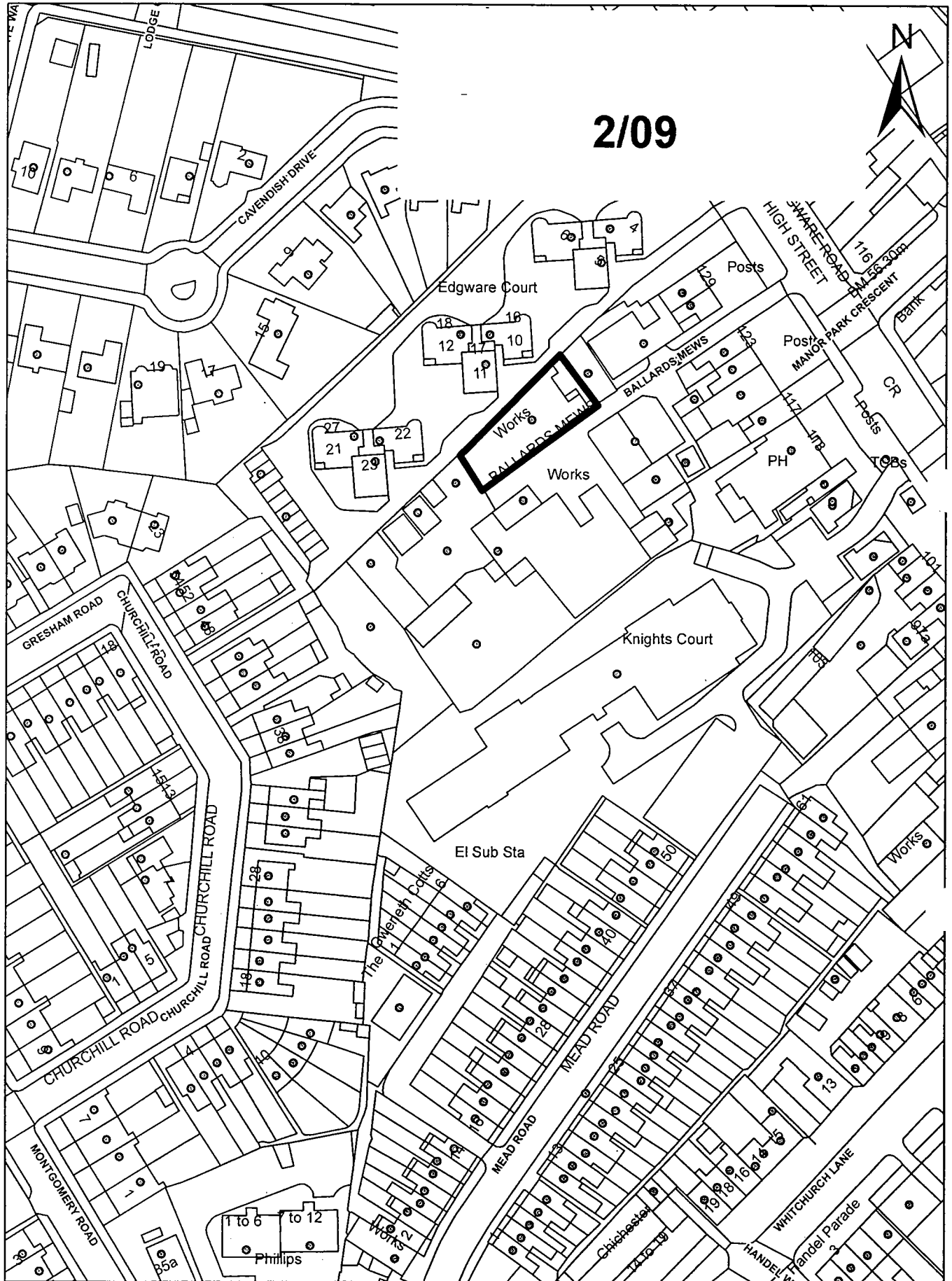

# 74 Alicia Avenue

2/10

This map is reproduced from Ordnance Survey material with the permission of Ordnance Survey on behalf of the controller of Her Majesty's Stationery Office. Crown Copyright. Unauthorised reproduction infringes Crown Copyright and may lead to prosecutions or civil proceedings. London Borough of Harrow LA.100019206. 2007.

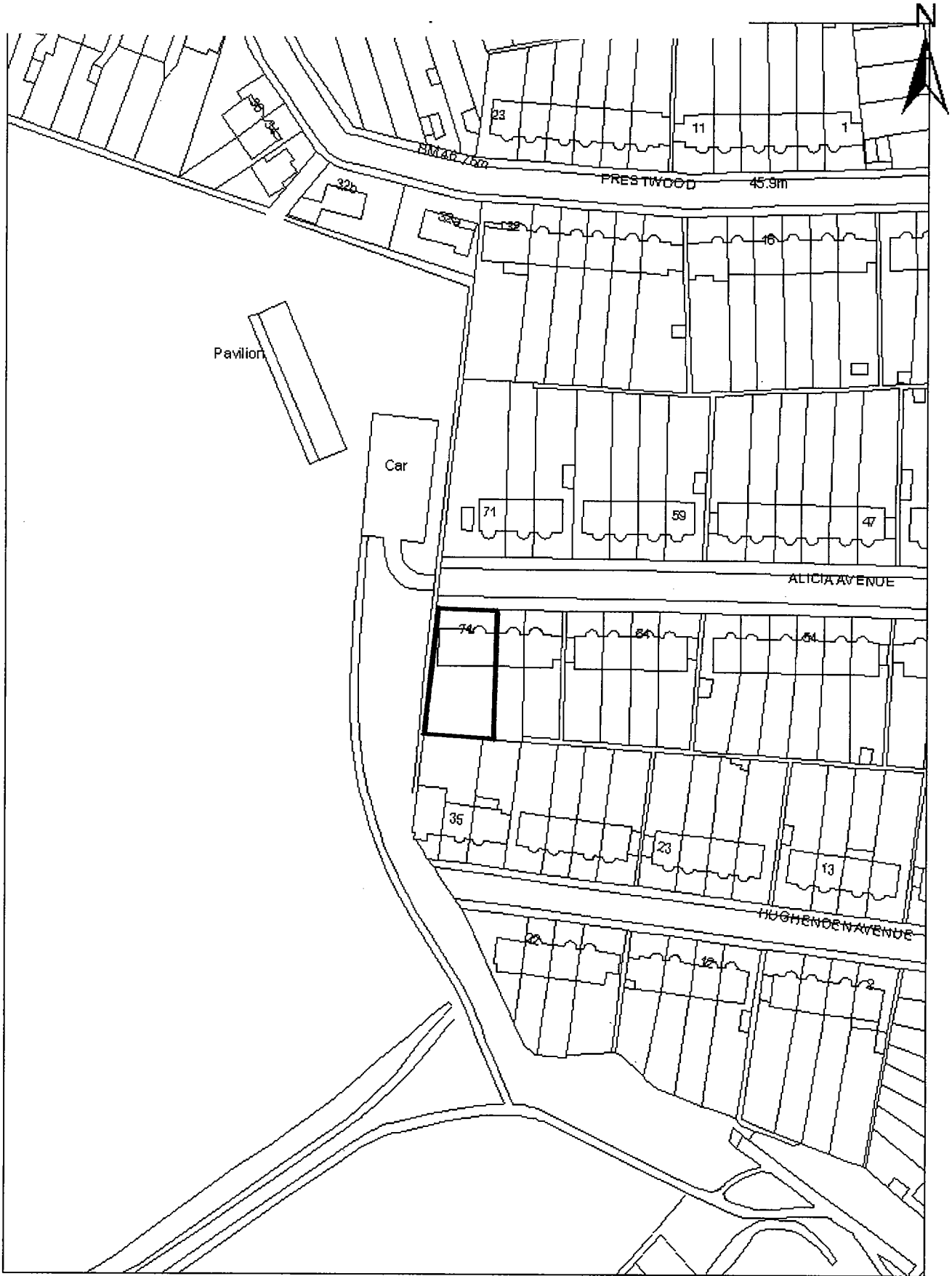

This map is reproduced from Ordnance Survey material with the permission of Ordnance Survey on behalf of the controller of Her Majesty's Stationery Office. Crown Copyright. Unauthorised reproduction infringes Crown Copyright and may lead to prosecutions or civil proceedings. London Borough of Harrow LA. 100019206. 2007.



This map is reproduced from Ordnance Survey material with the permission of Ordnance Survey, on behalf of the controller of Her Majesty's Stationery Office. Crown Copyright. Unauthorised reproduction infringes Crown Copyright and may lead to prosecutions or civil proceedings. London Borough of Harrow LA.100019206. 2007.

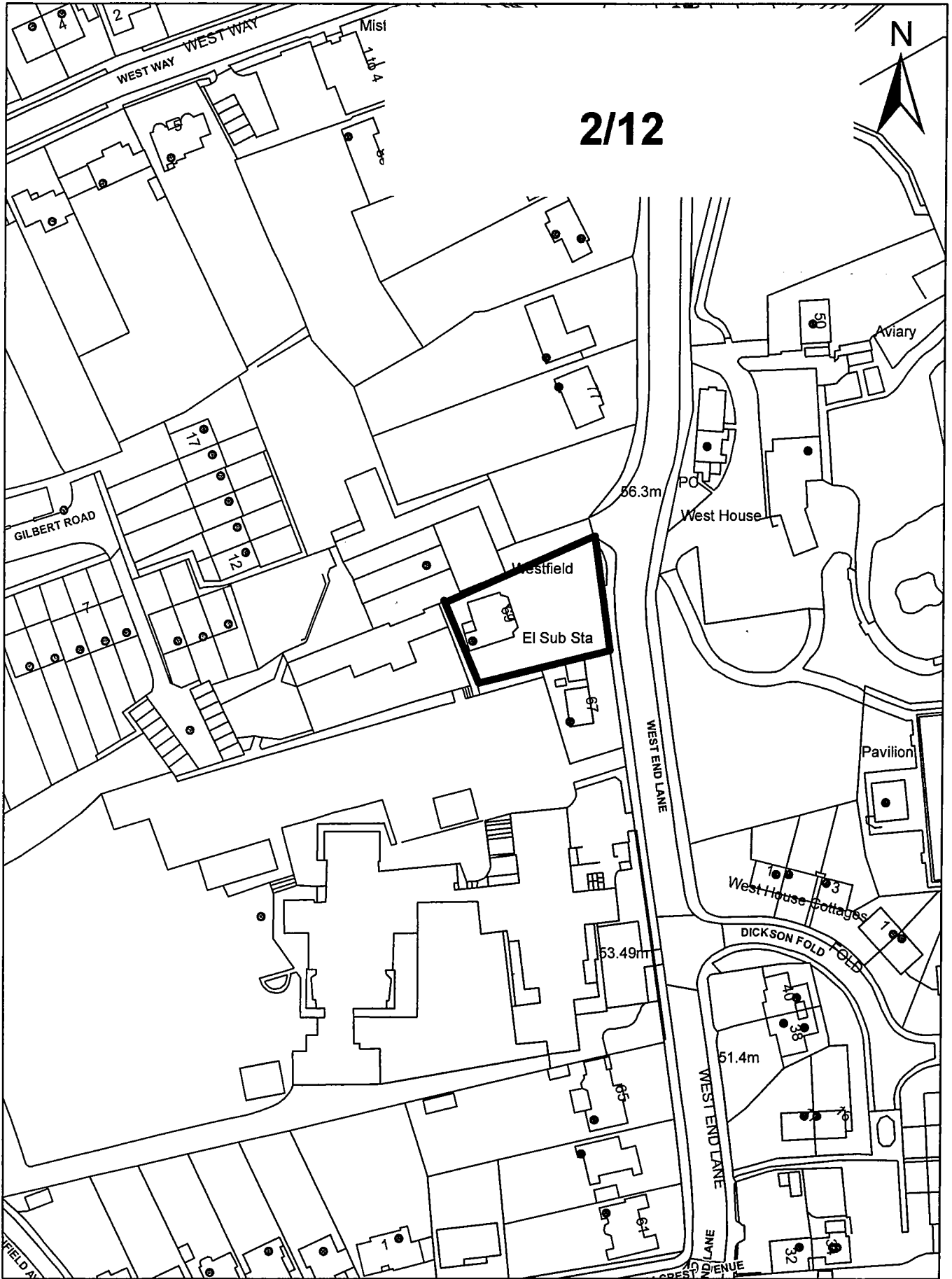

**2/13  
& 2/14**

Hatch End High School,  
Headstone Lane  
and  
Shaftesbury School, Long Elmes,  
Harrow Weald

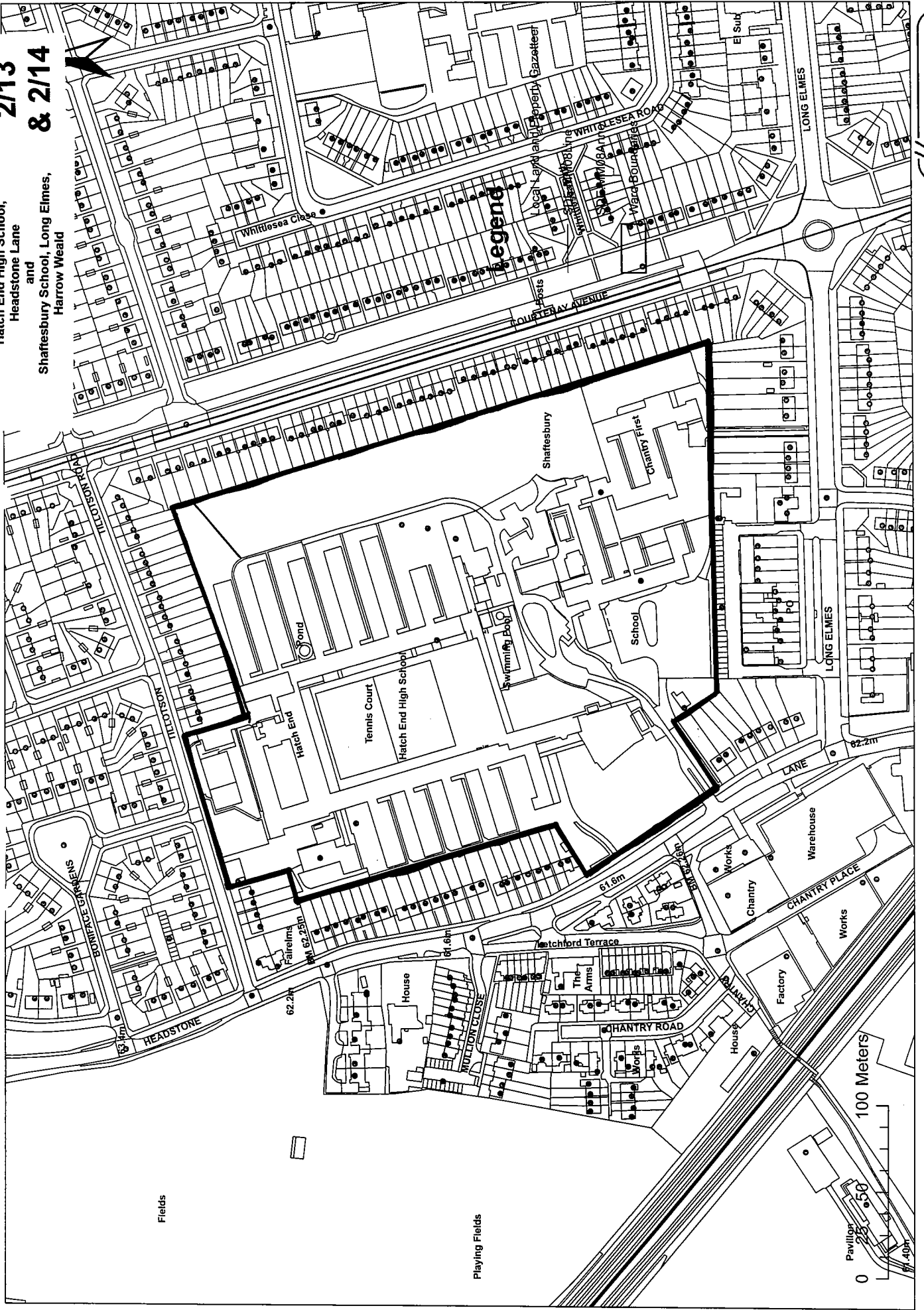

**Harrow**  
COUNCIL  
LONDON

This map is reproduced from Ordnance Survey material with the permission of Ordnance Survey on behalf of the controller of Her Majesty's Stationery Office. Crown Copyright.  
Unauthorised reproduction infringes Crown Copyright and may lead to prosecutions or civil proceedings. London Borough of Harrow LA.100019206. 2007.

This map is reproduced from Ordnance Survey, material with the permission of Ordnance Survey on behalf of the controller of Her Majesty's Stationery Office. Crown Copyright. Unauthorised reproduction infringes Crown Copyright and may lead to prosecutions or civil proceedings. London Borough of Harrow LA.100019206. 2007.

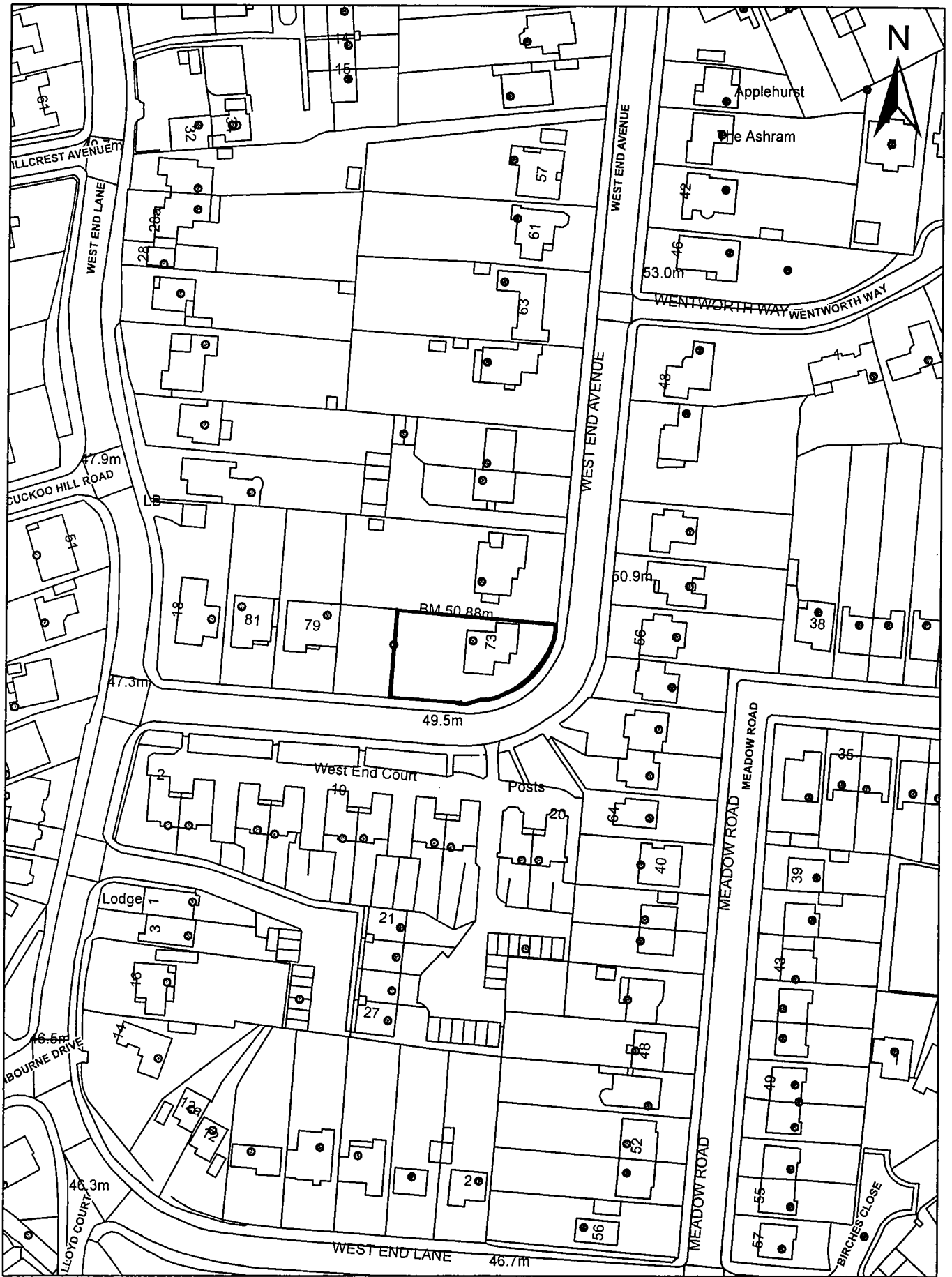

This map is reproduced from Ordnance Survey material with the permission of Ordnance Survey, on behalf of the controller of Her Majesty's Stationery Office. Crown Copyright. Unauthorised reproduction infringes Crown Copyright and may lead to prosecutions or civil proceedings. London Borough of Harrow LA.100019206. 2007.

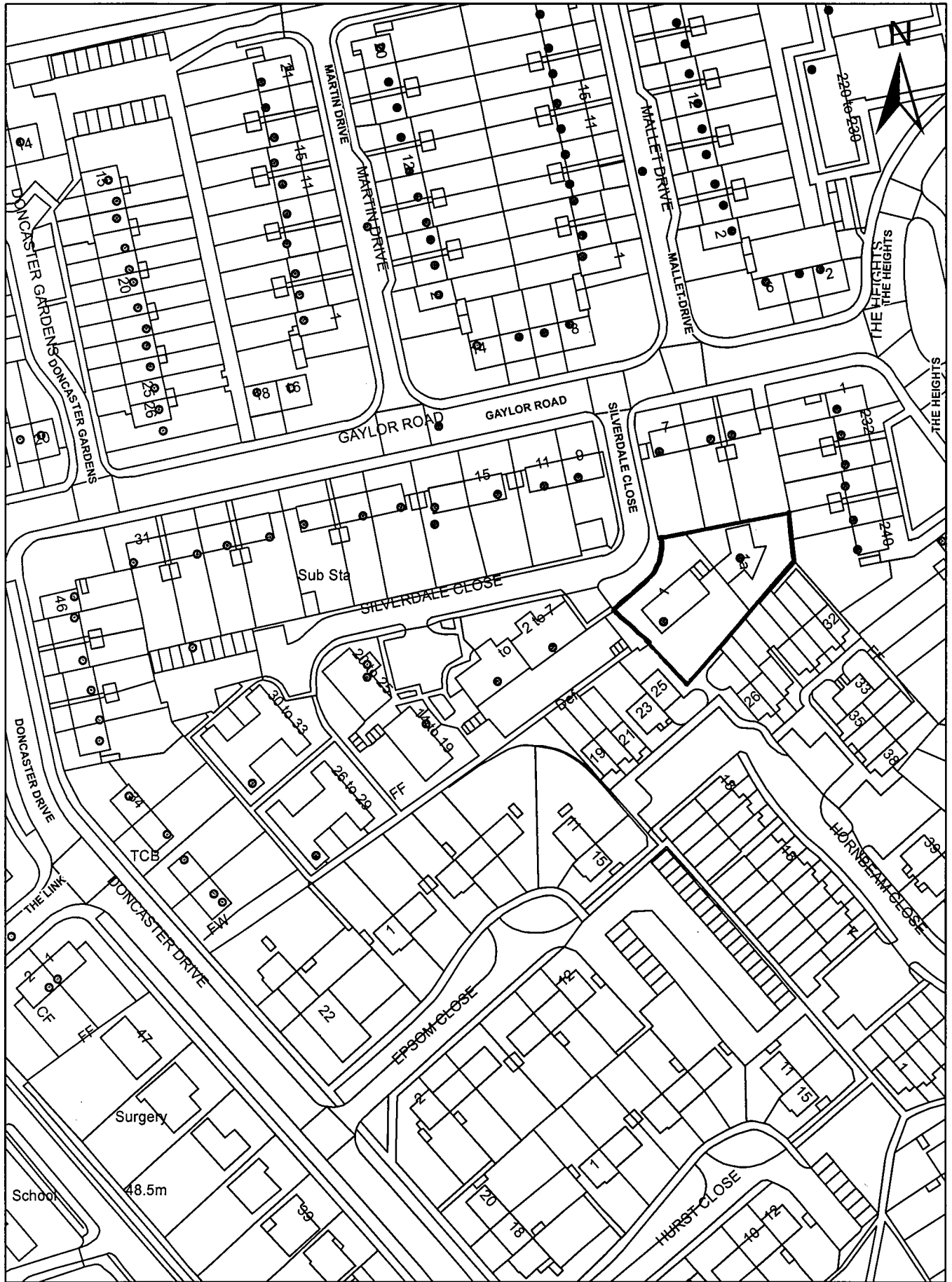

This map is reproduced from Ordnance Survey material with the permission of Ordnance Survey on behalf of the controller of Her Majesty's Stationery Office. Crown Copyright. Unauthorised reproduction infringes Crown Copyright and may lead to prosecutions or civil proceedings. London Borough of Harrow LA.100019206. 2007.

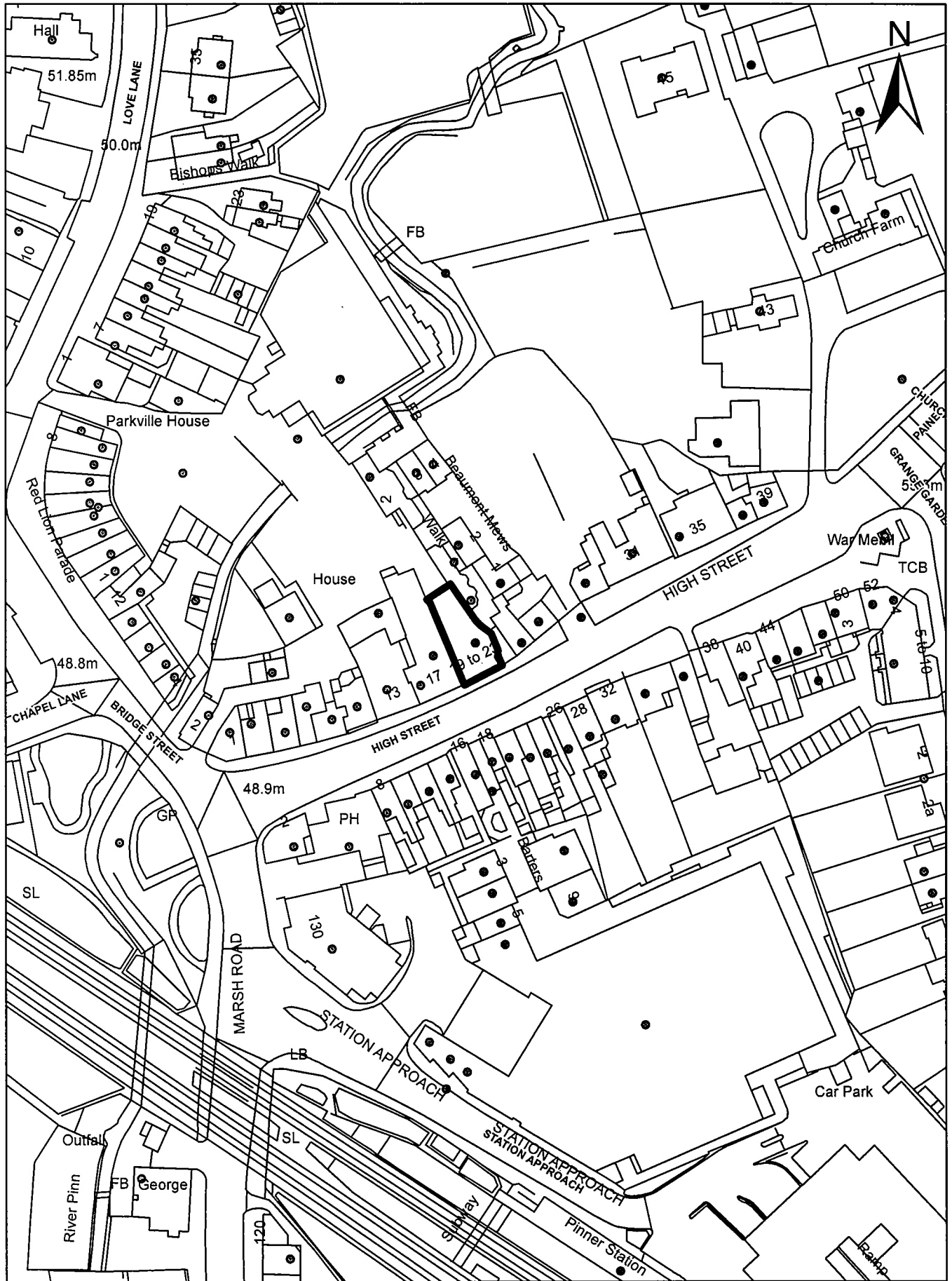



79 College Road, Harrow HA1 1FB

This map is reproduced from Ordnance Survey material with the permission of Ordnance Survey, on behalf of the controller of Her Majesty's Stationery Office. Crown Copyright. Unauthorised reproduction infringes Crown Copyright and may lead to prosecutions or civil proceedings. London Borough of Harrow LA.100019206. 2007.

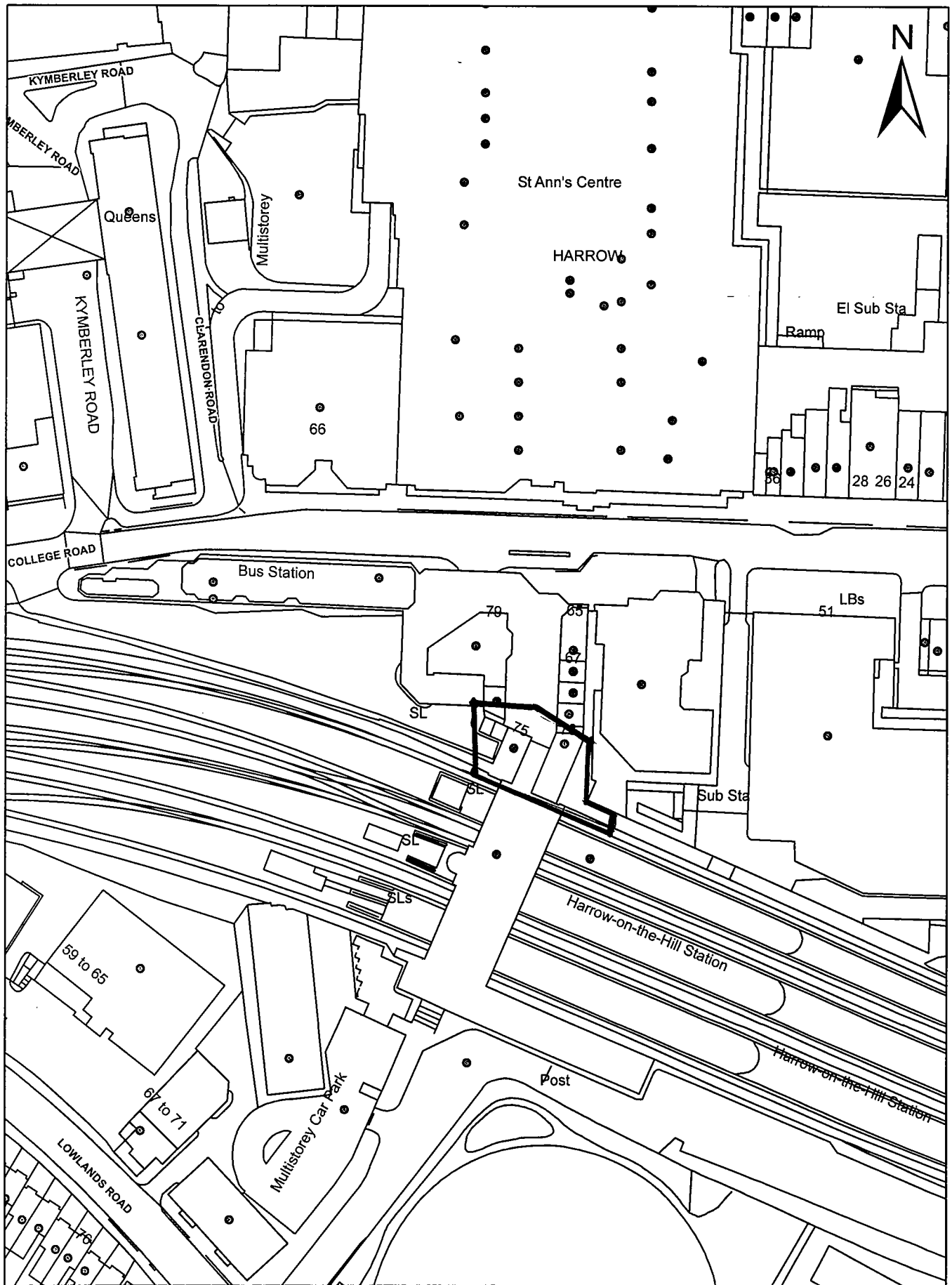

Land adj substation r/o Warwick Court  
Princes Drive, Harrow HA1

5/02

This map is reproduced from Ordnance Survey material with the permission of Ordnance Survey, on behalf of the controller of Her Majesty's Stationery Office. Crown Copyright. Unauthorised reproduction infringes Crown Copyright and may lead to prosecutions or civil proceedings. London Borough of Harrow LA.1000192006. 2007.

